

Via Conegliano, n.96 int.8/A
31058 Susegana (TV)
P.I: IT05015000267
Email: info@khamatech.com
Tel. +39 0438 1791275

CATALOGUE

PNEUMATIC TAPPING MACHINES

PKD SERIES-B12

TECHNICAL FEATURES

- Pneumatic Motor
- Double articulated arm
- Adjustable Gas Springs
- Multidirectional head
- Tapping in all directions
- Working radius 1350 mm
- Positioning magnet for correct alignment
- Ergonomic handle with controls
- Graduated protractor on head for precision tapping
- Air Connection ¼" GAS
- Spindle B12 ø19 mm
- Go and return tapping control with an easy lever



CODE	MODEL	TAPPING CAPACITY	TORQUE	SPEED	SPINDLE	WATT	AIR CONNECTION
020198119PD1	PDK-8-1	M2-M8	16 Nm	650 Rpm	B12 (ø19 mm)	300	1/4" GAS
201912119PD1	PDK-12-1	M2-M12	24 Nm	310 Rpm	B12 (ø19 mm)	220	1/4" GAS
201914119PD1	PDK-14-1	M2-M14	28 Nm	350 Rpm	B12 (ø19 mm)	300	1/4" GAS

Via Conegliano, n.96 int.8/A
31058 Susegana (TV)
P.I: IT05015000267
Email: info@khamatech.com
Tel. +39 0438 1791275

PKD SERIES-B16

TECHNICAL FEATURES

- Pneumatic Motor
- Double articulated arm
- Adjustable Gas Springs
- Multidirectional head
- Tapping in all directions
- Working radius 1350 mm
- Positioning magnet for correct alignment
- Ergonomic handle with controls
- Graduated protractor on head for precision tapping
- Air Connection 1/2" GAS
- Spindle B16 \varnothing 31 mm
- Go and return tapping control with an easy lever



CODE	MODEL	TAPPING CAPACITY	TORQUE	SPEED	SPINDLE	WATT	AIR CONNECTION
020198119PD2	PKD-12-2	M2-M12	28 Nm	600 Rpm	B16 (\varnothing 31 mm)	500	1/2" GAS
201912231PD2	PKD-16-2	M2-M16	38 Nm	450 Rpm	B16 (\varnothing 31 mm)	500	1/2" GAS
201916231PD2	PKD-20-2	M2-M20	64 Nm	270 Rpm	B16 (\varnothing 31 mm)	500	1/2" GAS

Via Conegliano, n.96 int.8/A
31058 Susegana (TV)
P.I: IT05015000267
Email: info@khamatech.com
Tel. +39 0438 1791275

PKT SERIES-B12

TECHNICAL FEATURES

- Pneumatic Motor
- Triple articulated arm
- Adjustable Gas Springs
- Multidirectional head
- Tapping in all directions
- Working radius 2000 mm
- Positioning magnet for correct alignment
- Ergonomic handle with controls
- Graduated protractor on head for precision tapping
- Air Connection ¼" GAS
- Spindle B12 \varnothing 19 mm
- Go and return tapping control with an easy lever



CODE	MODEL	TAPPING CAPACITY	TORQUE	SPEED	SPINDLE	WATT	AIR CONNECTION
020198119PT1	PKT-8-1	M2-M8	16 Nm	650 Rpm	B12 (\varnothing 19 mm)	300	1/4" GAS
201912119PT1	PKT-12-1	M2-M12	24 Nm	310 Rpm	B12 (\varnothing 19 mm)	220	1/4" GAS
201914119PT1	PKT-14-1	M2-M14	28 Nm	350 Rpm	B12 (\varnothing 19 mm)	300	1/4" GAS

Via Conegliano, n.96 int.8/A
 31058 Susegana (TV)
 P.I: IT05015000267
 Email: info@khamatech.com
 Tel. +39 0438 1791275

PKT SERIES-B16

TECHNICAL FEATURES

- Pneumatic Motor
- Double articulated arm
- Adjustable Gas Springs
- Multidirectional head
- Tapping in all directions
- Working radius 2000 mm
- Positioning magnet for correct alignment
- Ergonomic handle with controls
- Graduated protractor on head for precision tapping
- Air Connection 1/2" GAS
- Spindle B16 ϕ 31 mm
- Go and return tapping control with an easy lever



CODE	MODEL	TAPPING CAPACITY	TORQUE	SPEED	SPINDLE	WATT	AIR CONNECTION
020198231PT2	PKT-12-2	M2-M12	28 Nm	600 Rpm	B16 (ϕ 31 mm)	500	1/2" GAS
201916231PT2	PKT-16-2	M2-M16	38 Nm	450 Rpm	B16 (ϕ 31 mm)	500	1/2" GAS
201920231PT2	PKT-20-2	M2-M20	64 Nm	270 Rpm	B16 (ϕ 31 mm)	500	1/2" GAS
201930231PT2	PKT-30-2	M5-M30	180 Nm	100 Rpm	B16 (ϕ 31 mm)	500	1/2" GAS
201930S231PT2	PKT-30S-2	M2-M30	180 Nm	100/300 Rpm	B16 (ϕ 31 mm)	600	1/2" GAS

Via Conegliano, n.96 int.8/A
31058 Susegana (TV)
P.I: IT05015000267
Email: info@khamatech.com
Tel. +39 0438 1791275

ACCESSORIES

BUSHES FOR TAPS HOLDER G1

Bushes for taps holder with adjustable clutch \varnothing 19mm

Available from M2 to M16 (*)

(*) Ask for a quotation for bushes for taps holder without clutch, ISO or JIS measurements

PHOTO	CODE	TAPPING RANGE	STEM X FRAME	PRICE
	0228211B	M2	2,8X2,1	
	0335271B	M3	3,5X2,7	
	0445341B	M4	4,5X3,4	
	0056491B	M5	6X4,9	
	0066491B	M6	6X4,9	
	0088621B	M8	8X6,2	
	0101081B	M10	10X8	
	0012971B	M12	9X7	
	141191GB	M14 (grains)	11X9	
	161291GB	M16 (grains)	12X9	

G2-G1 BUSH REDUCTION FROM \varnothing 31mm TO \varnothing 19mm

With this accessory could be possible to use the bush for

Taps holder 1 (\varnothing 19mm) on the tapping machine with

Spindle attachment G2 (\varnothing 31mm)

CODE: 213119B	Price:
---------------	--------

Via Conegliano, n.96 int.8/A
 31058 Susegana (TV)
 P.I: IT05015000267
 Email: info@khamatech.com
 Tel. +39 0438 1791275

BUSHES FOR TAPS HOLDER G2

Bushes for taps holder with adjustable clutch ϕ 31mm

Available from M3 to M30 (*)

(*) Ask for a quotation for bushes for taps holder without clutch, ISO or JIS measurements

PHOTO	CODE	TAPPING RANGE	STEM X FRAME	PRICE
	00335272B	M3	3,5X2,7	
	00445342B	M4	4,5X3,4	
	00056492B	M5	6X4,9	
	00066492B	M6	6X4,9	
	00088622B	M8	8X6,2	
	00101082B	M10	10X8	
	00012972B	M12	9X7	
	01411912B	M14	11X9	
	01612912B	M16	12X9	
	01814112B	M18	14X11	
	02016122B	M20	16X12	
	22181452B	M22	18X14,5	
	24181452B	M24	18X14,5	
	2720162GB	M27 (grains)	20X16	
	3022182GB	M30 (grains)	22X18	

SPINDLE FOR CLAMPS HOLDER ER25-ER32

Spindle for clamps holder ER25-ER32 with attachment for ϕ 19mm or ϕ 31mm to ensure absolute tapping precision

Ask for a quotation also for ER20-ER40 models



CODE: G1ER20-316	Price:
CODE: G1ER25-320	Price:
CODE: G2ER25-320	Price:
CODE: G2ER32-327	Price:
CODE: G2ER40-627	Price:

Via Conegliano, n.96 int.8/A
31058 Susegana (TV)
P.I: IT05015000267
Email: info@khamatech.com
Tel. +39 0438 1791275

QUICK CHANGE TAPS HOLDER CLAMPS ERF25-ERF32

Quick change taps holder clamps available from M2,5 to M12
Measurement. They minimize the possibility of taps oscillation.
Ask for a quotation also for ERF20-ERF40



CODE: 2528212P	M2,5	2,8X2,1	Price:
CODE: 0335272P	M3	3,5X2,7	Price:
CODE: 0445342P	M4	4,5X3,4	Price:
CODE: 0005542P	M5	5X4	Price:
CODE: 0066492P	M6	6X4,9	Price:
CODE: 0107552P	M10	7X5,5	Price:
CODE: 0088622P	M8	8X6,2	Price:
CODE: 0012972P	M12	9X7	Price:

CHUCK-SPINDLE FOR DRILLS HOLDER

Chuck-Spindle for drills holder with quick change attachment
available in \varnothing 19mm or \varnothing 31mm version, for drills from 1-10mm or
from 1-13mm. It also possible to make countersink



CODE: G110	1-10mm	\varnothing 19mm	Price:
CODE: G113	1-13mm	\varnothing 19mm	Price:
CODE: G210	1-10mm	\varnothing 31mm	Price:
CODE: G213	1-13mm	\varnothing 31mm	Price:

Via Conegliano, n.96 int.8/A
31058 Susegana (TV)
P.I: IT05015000267
Email: info@khamatech.com
Tel. +39 0438 1791275

NEBULIZATION SYSTEM

Automatic nebulization system

Possibility to activate-deactivate the function via Joystick.

Recommended for tapping's series

To be used with correctly diluted spray oil



CODE: 1991920	Price:
---------------	--------

TROLLEY WITH WHEELS

Trolley with four wheels 900X750mm and locking system

in the desired position. Supplied with the appropriate holes for installation of the tapping flange.

Also available with additional tool holder support, positionable in any side of the trolley.



CODICE: 3118185	Price:
-----------------	--------

PLATE WITH T-SLOTS

Plate with T-slots 745 x 500 mm with a thickness of 30 mm.

Ideal for clamping the parts to be worked.

Possibility of fixing on our trolley with wheels or on other benches

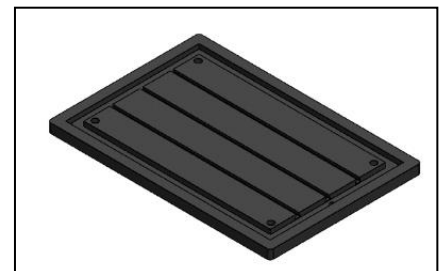

CODICE: 3118185-T	Price:
-------------------	--------

Via Conegliano, n.96 int.8/A
31058 Susegana (TV)
P.I: IT05015000267
Email: info@khamatech.com
Tel. +39 0438 1791275

TROLLEY WITH WHEELS AND PLATE WITH T-SLOTS

900X750mm trolley with four wheels and locking system

in the desired position. T-slot plate 745 x 500 mm with

thickness 30 mm. Ideal for clamping the parts to be worked.

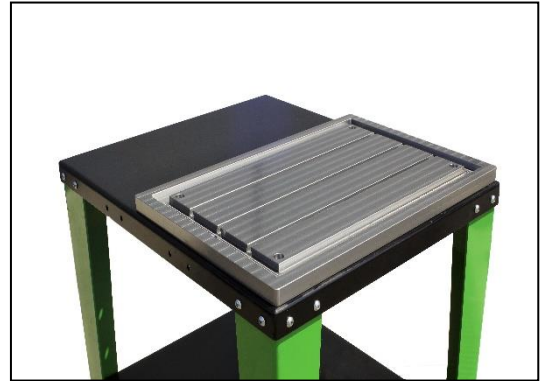

Supplied with the appropriate holes for installing the tapping flange.

Also available with additional tool holder cable, can be positioned on any side of the trolley.

Designed to become a real complete work station

CODICE: 3118185-CT	Prezzo:
--------------------	---------